

Battery Charger and Harnesses

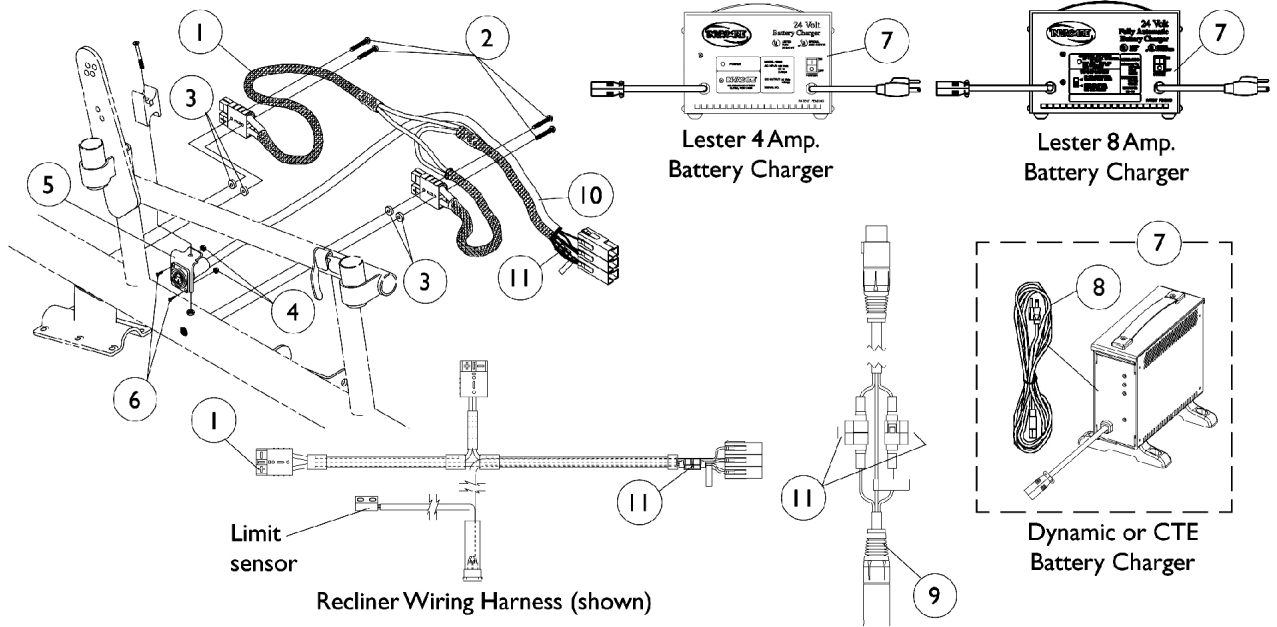

Battery Charger and Harnesses

Item Number	Note	Part Number	Description	Quantity Per	
				Package	Assembly
1		1053834-NLA	NLA - Harness, Wiring, Standard	1	1
1		1062466-NLA	NLA - Harness, Wiring, Recliner	1	1
2		1039773-NLA	NLA - Screw, Phillips Pan Head (#6-32 x 1-1/8")	1	4
3		1061323-NLA	NLA - Washer, Nylon (11/64 x 1/2 x 1/8")	1	2
4		P0870X000	Nut, Hex Keps (#4-40)	1	2
5		1053837-NLA	NLA - Bracket, Charger Connector, Black	1	1
6		1021742	Screw, Phillips Pan Head (#4-40 x 1/2")	1	1
7	A,J	1053161-NLA	NLA - Charger, Battery, 8 Amp, 115vac, Off Board Dual Mode Round Plug, Lester	1	1
7		1085678-NLA	NLA - Charger, Battery, 8 Amp. 115vac, Off Board, Dual Mode, Round Plug w/ AC Power Line Cord, Dynamic	1	1
7	D,G	1061411-NLA	NLA - Charger, Battery, 4 Amp. 115vac, Off Board, Dual Mode, Round Plug, Lester	1	1
7	H,H1	1123249	Charger, Battery, 8 Amp. 115vac (Off Board) Single Mode Round Plug w/ AC Power Line Cord	1	1
7	H,H1	1123249E-NLA	NLA - WARR RPLMT - Charger, Battery, 8 Amp, 115VAC (Off Board) Single Mode Round Plug w/ AC Power Line Cord	1	1
8	I	1089627-NLA	NLA - Cord, AC Power, 115VAC, 2 Prong Off-Board (11' 6" L)	1	1
8		1121086	Cord, AC Power, 115VAC, 3 Prong On-Board (6' 6-1/2" L)	1	1
9		1083929-NLA	NLA - Cable, Charger Extension, Round Plug (24" L)	1	1
10	B	1090357-NLA	NLA - Wrap, Slit Wire Harness (1/2" O.D., 36" Long Cut To Length)	1	1
11	E	1098892-NLA	NLA - Fuse - Buss ATC-15 (15 AMP)	1	2
11	F	1090117-NLA	NLA - Fuse - Buss Mini ATM-15 (15 AMP)	1	2
	C	1095502-NLA	NLA - Package, Tie Wrap (11-1/2" L)	10	1

NOTE: A - On 7/18/01 Lester 8 AMP battery charger was reinstated.
 B - Plastic wire wrap replaced mesh fabric and heat shrink 9/1/99. #1090357 can be used for chairs made before 9/1/99.
 C - Not Shown
 D - Light Duty, 250-S Models Only.
 E - Before 4/1/03. Charger extension cable requires 1 fuse. Wiring harness requires 2 fuses
 F - After 3/31/03. Charger extension cable requires 2 fuses. Wiring harness requires 2 fuses
 G - The 4 amp. Lester charger was obsoleted and replaced with the 8 amp. CTE charger. For wet cell batteries, use the 8 amp. dual mode Lester charger.
 H - CTE charger introduced 4/1/04. Used on Gel Cell or AGM (Absorbed Glass Mat) batteries. For wet cell batteries refer to the 8 amp. Lester charger.
 H1 - CTE charger looks exactly the same as Dynamic's charger except for the company name that is silk screened on the narrow side panel, where the charger plug is (hard wired) attached. Serial number starts with 04A00000001.
 I - No longer available as a service part. Please use 1121086 as its replacement.
 J - Use Battery Charger part number 1123249 as a replacement.