

Battery Chargers - Straps & Hardware

Before 12/19/03

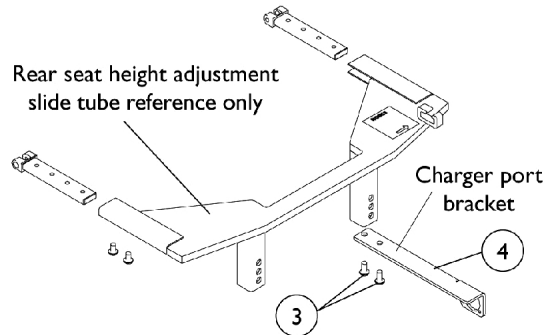

Charger port bracket location when a Power Tilt Only (PTO) system w/ MKIV A electronics are present

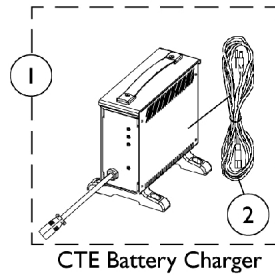
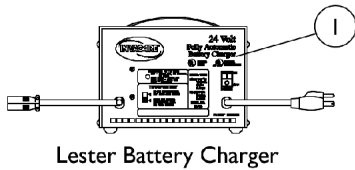
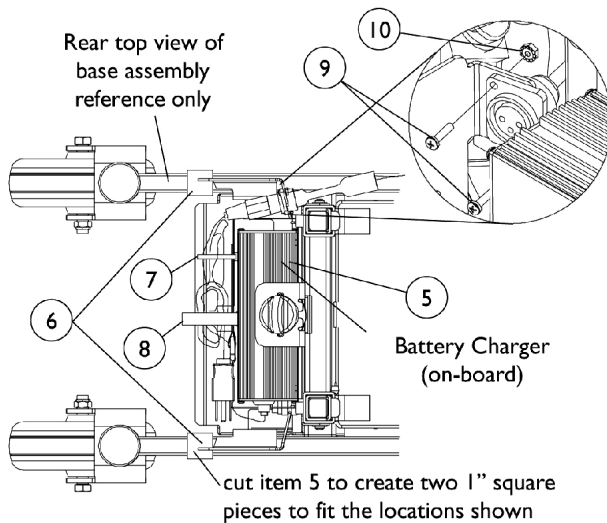

NOTE: On-board charger is not used when a Power Tilt Only (PTO) system is present

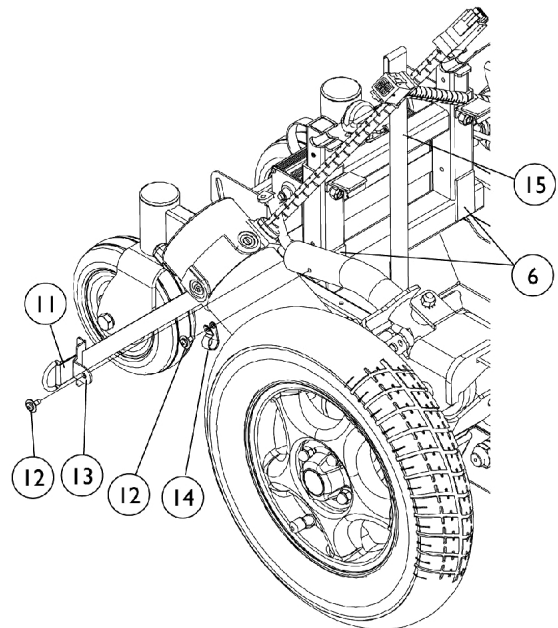

Battery Chargers - Straps & Hardware

Before 12/19/03

Item Number	Note	Part Number	Description	Quantity Per	
				Package	Assembly
1	A,E	1053161-NLA	NLA - Charger, Battery, 8 Amp, 115vac, Off Board Dual Mode Round Plug, Lester	1	1
1	C	1123249	Charger, Battery, 8 Amp. 115vac (Off Board) Single Mode Round Plug w/ AC Power Line Cord	1	1
1	C	1123249E-NLA	NLA - WARR RPLMT - Charger, Battery, 8 Amp, 115VAC (Off Board) Single Mode Round Plug w/ AC Power Line Cord	1	1
2	D	1089627-NLA	NLA - Cord, AC Power, 115VAC, 2 Prong Off-Board (11' 6" L)	1	1
2		1121086	Cord, AC Power, 115VAC, 3 Prong On-Board (6' 6-1/2" L)	1	1
3		1006773-NLA	NLA - Screw, Socket Button Head (1/4-20 x 1/2")	1	1
4		1119265-NLA	NLA - Bracket, Charger Connector, Black	1	1
5	B	1110636-NLA	NLA - Charger, Battery, Dual Mode, Round Plug, 5 Amp, On-Board	1	1
6		1070509-NLA	NLA - Fastener, Loop with Adhesive Back (1" W x 2" L)	1	3
7		1095502-NLA	NLA - Package, Tie Wrap (11-1/2" L)	10	1
8		1112745-NLA	NLA - Tie Wrap, Hook and Loop (8" L)	1	1
9		1021742	Screw, Phillips Pan Head (#4-40 x 1/2")	1	4
10		P0870X000	Nut, Hex Keps (#4-40)	1	4
11		1112569-NLA	NLA - Strap, Charger	1	1
12		1114308	Screw, Phillips Pan Head Tap (#10-32 x 1/2")	1	4
13		1113441-NLA	NLA - Tab, Charger Strap	1	2
14		1110638-NLA	NLA - Clamp, Cable (1/2 x 3/8")	1	2
15		1080872-NLA	NLA - Strap and Buckle Assembly	1	1
NOTE: A - The 8 Amp. Lester charger was standard on-chair when a Power Tilt Only (PTO) seating system is ordered B - Used on all chairs except those with a Power Tilt Only (PTO) seating system. C - CTE charger introduced 4/1/04. Used on Gel Cell or AGM (Absorbed Glass Mat) batteries. Serial number starts with 04A00000001. For wet cell batteries refer to the Lester 8 Amp. charger. D - No longer available as a service part. Please use 1121086 as its replacement. E - Use Battery Charger part number 1123249 as a replacement.					