

# Battery Chargers & MKIV Harnesses

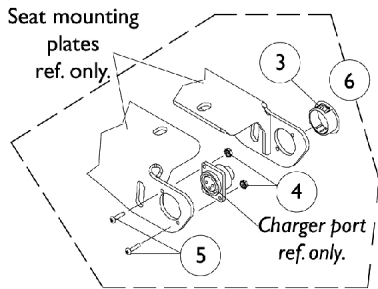

**A.S.B.A. Seat and Captain Seat  
Charger Port Mounting**

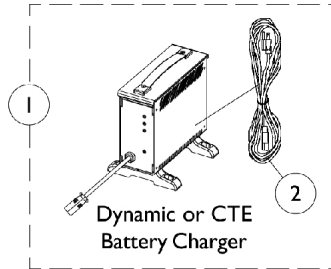
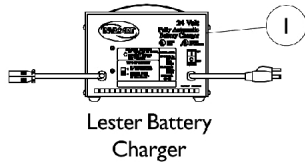
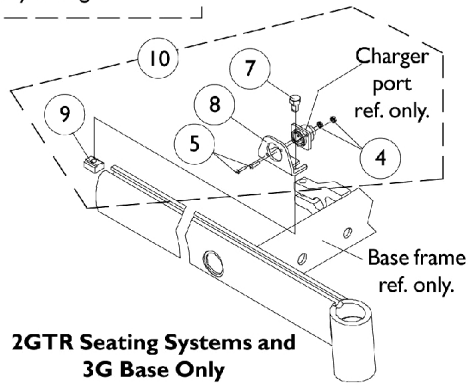

**2GTR Seating Systems and  
3G Base Only  
Charger Port Mounting**

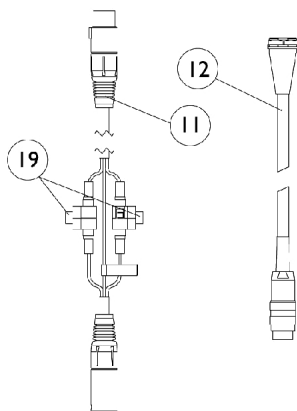
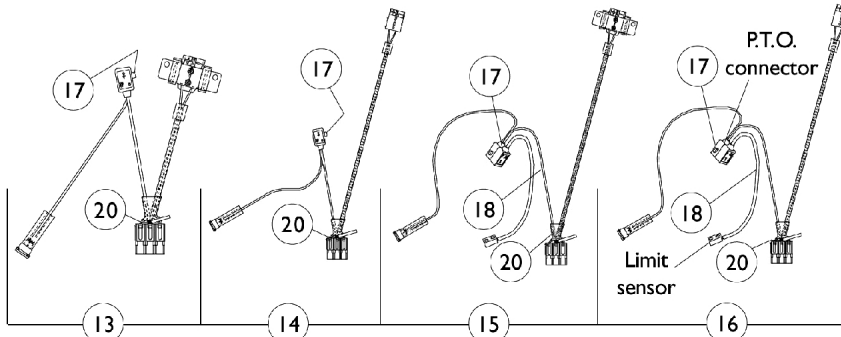

**GP 24 battery harness for  
R11 80 AMP. controller**

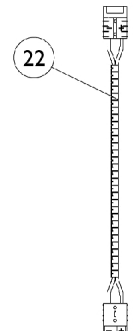
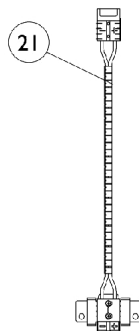

**22NF battery harness for  
R11 80 AMP. controller**

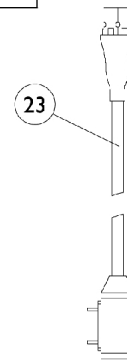

## Battery Chargers & MKIV Harnesses

Item Number	Note	Part Number	Description	Quantity Per	
				Package	Assembly
1	A,Q	1053161-NLA	NLA - Charger, Battery, 8 Amp, 115vac, Off Board Dual Mode Round Plug, Lester	1	1
1		1085678-NLA	NLA - Charger, Battery, 8 Amp. 115vac, Off Board, Dual Mode, Round Plug w/ AC Power Line Cord, Dynamic	1	1
1	O,O1	1123249	Charger, Battery, 8 Amp. 115vac (Off Board) Single Mode Round Plug w/ AC Power Line Cord	1	1
1	O,O1	1123249E-NLA	NLA - WARR RPLMT - Charger, Battery, 8 Amp, 115VAC (Off Board) Single Mode Round Plug w/ AC Power Line Cord	1	1
2	P	1089627-NLA	NLA - Cord, AC Power, 115VAC, 2 Prong Off-Board (11' 6" L)	1	1
2		1121086	Cord, AC Power, 115VAC, 3 Prong On-Board (6' 6-1/2" L)	1	1
3		1104803-NLA	NLA - Plug Button, Black (1")	1	1
4		P0870X000	Nut, Hex Keps (#4-40)	1	2
5		7930318-NLA	NLA - Package, Screw, Phillips Pan Head (#4-40 x 1/2")	25	2
6	D	1104864	Hardware, Charger Port Mounting	1	1
7		1061922-NLA	NLA - Screw, Hex Head w/ Patch (5/16-18 x 1/2")	1	1
8		1070430-NLA	NLA - Bracket, Charger Connector, Black	1	1
9		1069724	T-Nut (5/16-18)	1	1
10	E	1104865-NLA	NLA - Hardware, Charger Port Mounting	1	1
11		1083929-NLA	NLA - Cable, Charger Extension, Round Plug (24" L)	1	1
12	B	1092912-NLA	NLA - Programmer Extension Cable Assembly (18" Long)	1	1
13	G,K	1092314	Harness, Wiring, Black Battery Connector, Round Plug, GP24 Dual Battery Box	1	1
13	L,M	1124821	Harness, Wiring w/ Red Battery Connector, Round Plug, GP24 Dual Battery Boxes	1	1
14	G	1092306-NLA	NLA - Harness, Wiring, Round Plug, 22NF Single Battery Box	1	1
15	H,N	1095265-NLA	NLA - Harness, Wiring, Round Plug, GP24 Dual Battery Box	1	1
16	H	1095266-NLA	NLA - Harness, Wiring, Round Plug, 22NF Single Battery Box	1	1
17		1090117-NLA	NLA - Fuse - Buss Mini ATM-15 (15 AMP)	1	1
18	C	1092913-NLA	NLA - Cable, Drive Lockout Sensor	1	1
19	I	1098892-NLA	NLA - Fuse - Buss ATC-15 (15 AMP)	1	1
19	J	1090117-NLA	NLA - Fuse - Buss Mini ATM-15 (15 AMP)	1	2
20	I	1101099-NLA	NLA - Fuse, Buss ATC-20 (20 AMP)	1	1
20	J	1119230-NLA	NLA - Fuse - Buss Mini ATM-20 (20 AMP)	1	1
21		1109509-NLA	NLA - Harness, Battery (GP24)	1	1
22		1107296-NLA	NLA - Harness, Battery (22NF)	1	1
23		1098905-NLA	NLA - Cable Assembly, 24 Volt, Anderson/P.T.O.	1	1
	F	1095502-NLA	NLA - Package, Tie Wrap (11-1/2" L)	1	1
	F	1108970-NLA	NLA - Package, Tie Wrap (3-7/8" L)	1	1

## Battery Chargers & MKIV Harnesses

Item Number	Note	Part Number	Description	Quantity Per	
				Package	Assembly
	F	1090357-NLA	NLA - Wrap, Slit Wire Harness (1/2" O.D., 36" Long Cut To Length)	1	1
<p>NOTE: A - On 7/18/01 the Lester 8 amp. battery charger was introduced to 3G Storm Series chairs.            B - Used only when a 2GTR powered seating systems are ordered.            C - For manual recliners and high back captain seats.            D - Includes items 3-5            E - Includes items 4, 5, 7-9            F - Not Shown            G - For A.S.B.A. non-recliner, all powered seating systems and high back semi recline captain seats            H - For A.S.B.A. manual recliner and high back full recline captain seats            I - Before 4/1/03            J - After 3/31/03            K - For all 4-pole motors and all GB non-heavy duty and (GB heavy duty TTHD motors before 1/26/04)            L - For GB Heavy Duty TTHD motors after 1/25/04 only. GB Non-Heavy Duty motors no longer offered after 1/25/04.            M - For A.S.B.A. manual recliner and high back full recline captain seats, item 18 sensor cable must be ordered as well.            N - For models equipped with GB heavy duty motors after 1/25/04, order item 13 wire harness part number 1124821 and item 18 sensor cable part number 1092913.            O - CTE charger introduced and standard on-chair 4/1/04. Used on Gel Cell or AGM (Absorbed Glass Mat) batteries. For wet cell batteries refer to the Lester charger.            O1 - CTE charger looks exactly the same as Dynamic's charger except for the company name that is silk screened on the narrow side panel, where the charger plug is (hard wired) attached. Serial number starts with 04A00000001.            P - No longer available as a service part, please use 1121086 as its replacement.            Q - Use Battery Charger part number 1123249 as a replacement.</p>					