

# Van Seat Frame & Actuator Hardware

**NOTE:** Seat Release Hardware is not included with a Van Seat Frame. See page titled "Seat Release Hardware".

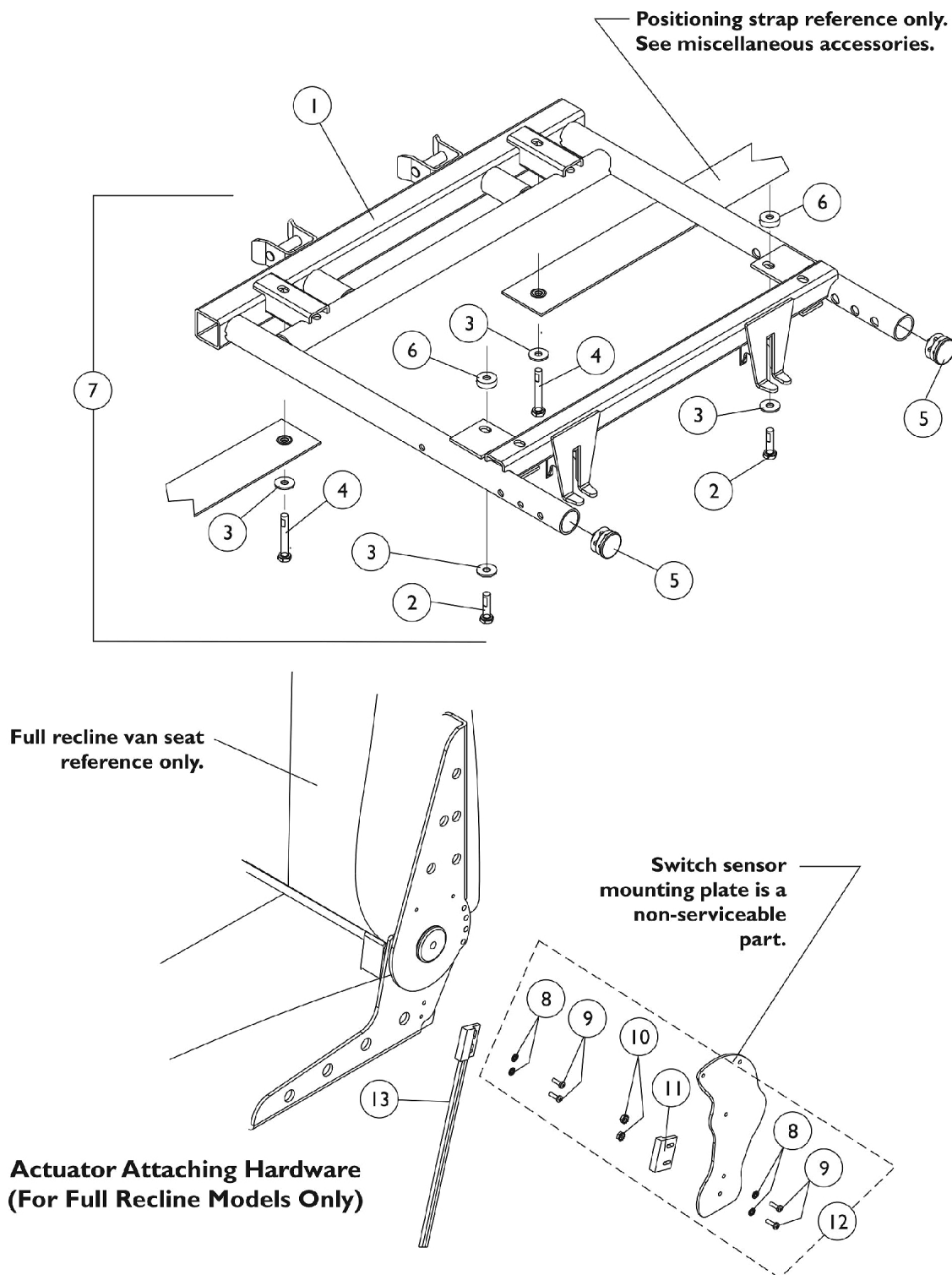

# Van Seat Frame & Actuator Hardware

**NOTE: Seat Release Hardware is not included with a Van Seat Frame. See page titled "Seat Release Hardware".**

| Item Number  | Note | Part Number | Description  | Quantity Per |          |
|--|------|-------------|--|--------------|----------|
|  |      |             |  | Package      | Assembly |
| 1  | C    | 1123423-NLA | NLA - Frame, Van Seat, Black (16" W)                   | 1            | 1        |
| 1  | C    | 1115343     | Frame, Van Seat, Black (18" W)                         | 1            | 1        |
| 1  | C    | 1115344     | Frame, Van Seat, Black (20" W)                         | 1            | 1        |
| 1  | C    | 1115345     | Frame, Van Seat, Black (22" W)                         | 1            | 1        |
| 2  |      | 1088897-NLA | NLA - Screw, Hex Head w/ Patch (1/4-20 x 1-1/4")       | 1            | 2        |
| 3  |      | 1026900     | Washer (1/4 x 23/32 x 1/16")                           | 1            | 2        |
| 4  |      | 1052957     | Screw, Hex Head w/ Patch (1/4-20 x 2")                 | 1            | 2        |
| 5  |      | 1029501     | Plug Button, Black (1")                                | 1            | 2        |
| 6  |      | 1108410     | Spacer (1/4 x 5/8 x 1/4")                              | 1            | 2        |
| 7  | A    | 1116421     | Hardware, Van Seat Mounting                            | 1            | 1        |
| 8  |      | 1008525-NLA | NLA - Washer, Internal Tooth Lock (#4-40)              | 1            | 4        |
| 9  |      | 7930339-NLA | NLA - Package, Screw, Phillips Pan Head (#4-40 x 3/8") | 25           | 4        |
| 10   |      | P0870X000   | Nut, Hex Keps (#4-40)                                  | 1            | 2        |
| 11   |      | 1024001     | Sensor, Actuator Switch                                | 1            | 1        |
| 12   | B    | 1107242-NLA | NLA - Hardware, Actuator Switch Sensor Mounting        | 1            | 1        |
| 13   |      | 1074983-NLA | NLA - Cable, Limit Switch Sensor                       | 1            | 1        |
| NOTE: A - Includes items 2-6<br>B - Includes items 8-11<br>C - NOTE: Seat Release Hardware is not included with a Van Seat Frame. See page titled "Seat Release Hardware". |      |             |  |              |          |