

# Front Rigging Hanger Assembly

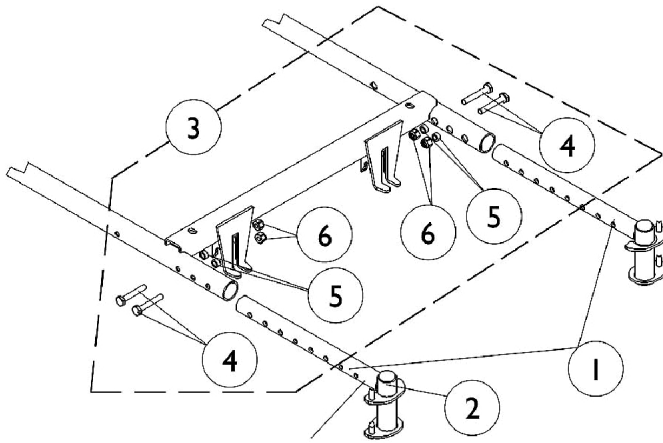

**For Van Seats**

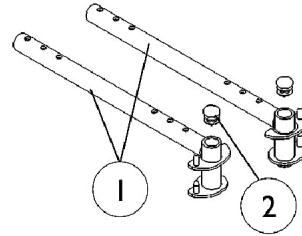

**For A.S.B.A.  
Seats**

**NOTE:** Front rigging hanger and seat pans share the same mounting hardware for an A.S.B.A. seat. See "seat pan and hardware" category.

## Front Rigging Hanger Assembly

Item Number	Note	Part Number	Description	Quantity Per	
				Package	Assembly
1	A	1113026	Front Rigging Hanger Assembly w/ Plug Button, Hemi, Black - Right	1	1
1	A	1113027	Front Rigging Hanger Assembly w/ Plug Button, Hemi, Black - Left	1	1
1	B	1114766	Front Rigging Hanger Assembly w/ Plug Button, Pin Style, Hemi, Black - Right (12 - 21" D)	1	1
1	B	1114767	Front Rigging Hanger Assembly w/ Plug Button, Pin Style, Hemi, Black - Left (12 - 21" D)	1	1
1	D	1132339-NLA	NLA - Front Rigging Hanger Assembly w/ Plug Button, Pin Style, Hemi, Black - Right (22" D)	1	1
1	D	1132340-NLA	NLA - Front Rigging Hanger Assembly w/ Plug Button, Pin Style, Hemi, Black - Left (22" D)	1	1
2		1027097	Plug Button, Black (3/4")	1	1
3	C	1113045	Kit, Front Rigging Hanger Hardware	1	1
4			Locknut (1/4-20)	1	4
5			NLA - Spacer (1/4 x 3/8 x 3/16")	1	4
6			Screw, Hex Head (1/4-20 x 1-1/2")	1	4
<p>NOTE: A - Used on chairs with Van seats. Includes Plug Button, item 2.            B - 16-21" deep chairs with A.S.B.A. seats. Includes Plug Button, item 2.            C - Includes items 4-6.            D - 22" deep chairs with A.S.B.A. seats. Includes Plug Button, item 2.</p>					