

# Drive Wheel Assembly

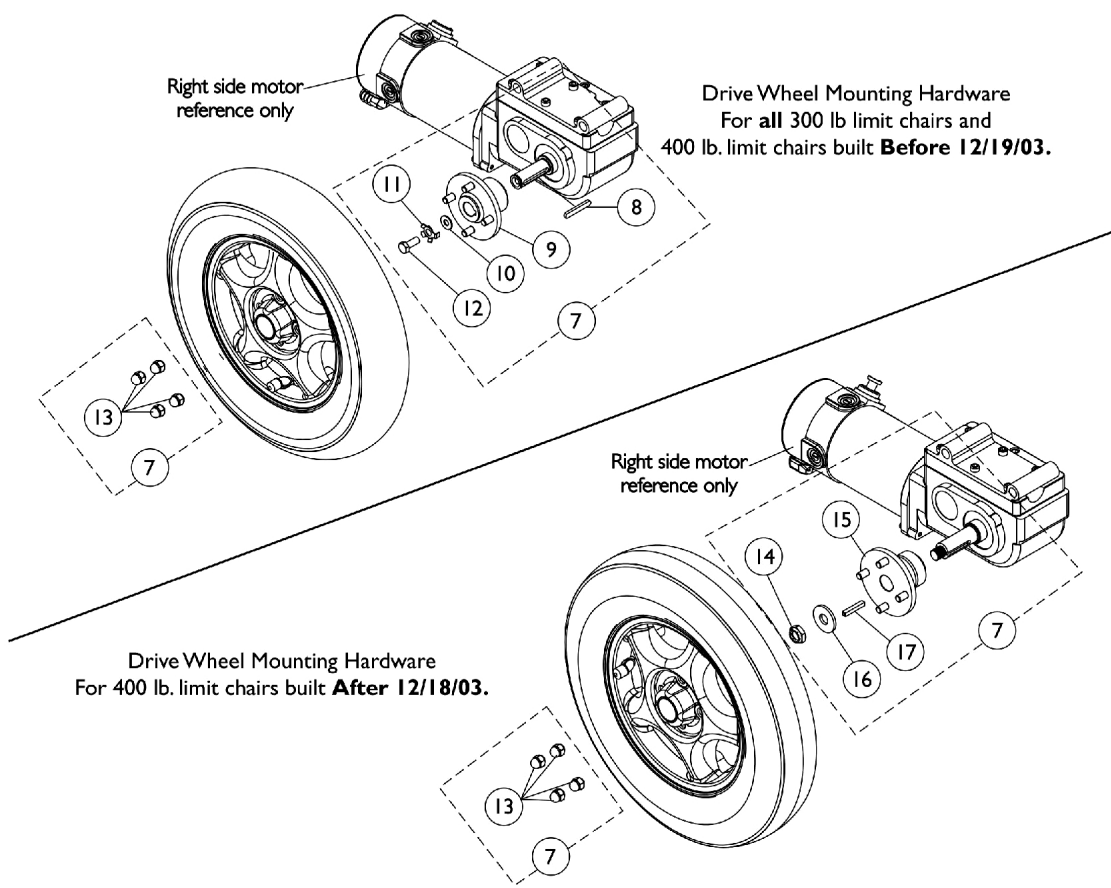
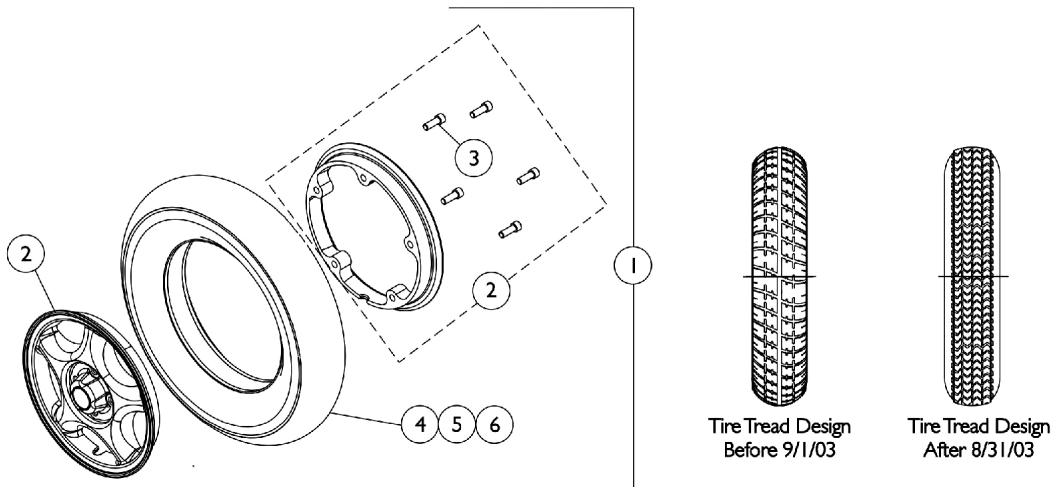

# Drive Wheel Assembly

Item Number	Note	Part Number	Description	Quantity Per	
				Package	Assembly
1	C	1104438	Drive Wheel Assembly, Pneumatic, Grey Tire/Silver Rim (14 x 3")	1	1
1		1122792	Drive Wheel Assembly, Pneumatic, Grey Tire/Silver Rim (14" x 3") (Pair)	2	1
1	C,E	1104437	Drive Wheel Assembly, Flat Free, Grey Tire/Silver Rim (14 x 3")	1	1
1	E	1122793	Drive Wheel Assembly, Flat Free, Grey Tire/Silver Rim (14" x 3") (Pair)	2	1
1	F	1141343	Drive Wheel Assembly, Flat Free, Grey Tire/Silver Rim (14 x 3")	1	1
2	A	1104882-NLA	NLA - Kit, 8" Rim w/ Hardware (14 x 3" Wheel)	1	1
4	C	1039652	Tire, Pneumatic, Grey (14" x 3")	1	1
4		1122794	Tire, Pneumatic, Grey (14" x 3") (Pair)	2	1
5	C,E	1101754	Tire w/ Foam Fill Insert, Grey (14" x 3")	1	1
5	E	1122795	Tire w/ Foam Fill Insert, Grey (14" x 3") (Pair)	2	1
5	F	1141342	Tire w/ Foam Fill Insert, Grey (14" x 3")	1	1
6		1039651	Tube, Inner, Black (14 x 3")	1	1
7	B	1115352	Kit, Drive Wheel Mounting Hardware (14" x 3")	1	1
7	D	1123400	Kit, Drive Wheel Mounting Hardware (14" x 3")	1	1
8		1023264	Key (6mm x 6mm x 40mm)	1	1
9		1110639	Hub, Wheel	1	1
10		1079247	Washer, Flat (21/64 x 53/64 x 7/64")	1	1
11		1064179	Kit, Locking Tab Washer w/ Instruction Sheet (Pair)	2	1
12		1023260	Screw (M8 x 1.25 x 20mm)	1	1
13		1100580	Nut, Beveled Hex (5/16-24)	1	4
14		1025737	Locknut (1/2-20)	1	1
15		1106174	Hub, Wheel	1	1
16		1036933	Washer (1/2 x 1-9/32 x 1/8")	1	1
17		1000180	Key (3/16 x 1-1/4")	1	1
<p>NOTE: A - Sold complete. Includes the Rims and (5) ea. Socket Head Screws w/ Patch (5/16-18 x 7/8")</p> <p>B - Includes items 8-13. For "ALL" 300 lb. weight limit wheelchairs and (400 lb. weight limit wheelchairs built Before 12/19/03).</p> <p>C - Tire tread design changed 9/1/03 to improve traction. The tread design is the same as the Storm Series TDX models. It is recommended to replace in pairs to match tread design and traction performance for chairs made before 9/1/03</p> <p>D - Includes items 13-17. For 400 lb. weight limit wheelchairs built After 12/18/03.</p> <p>E - Before 12/19/05. Contains a black colored high density flat free foam material.</p> <p>F - After 12/18/05. Contains a green colored low density flat free foam material that provides a softer ride. A customer's chair must have a matched color set of foam filled inserts.</p>					