

# Packaging, Literature and Decals

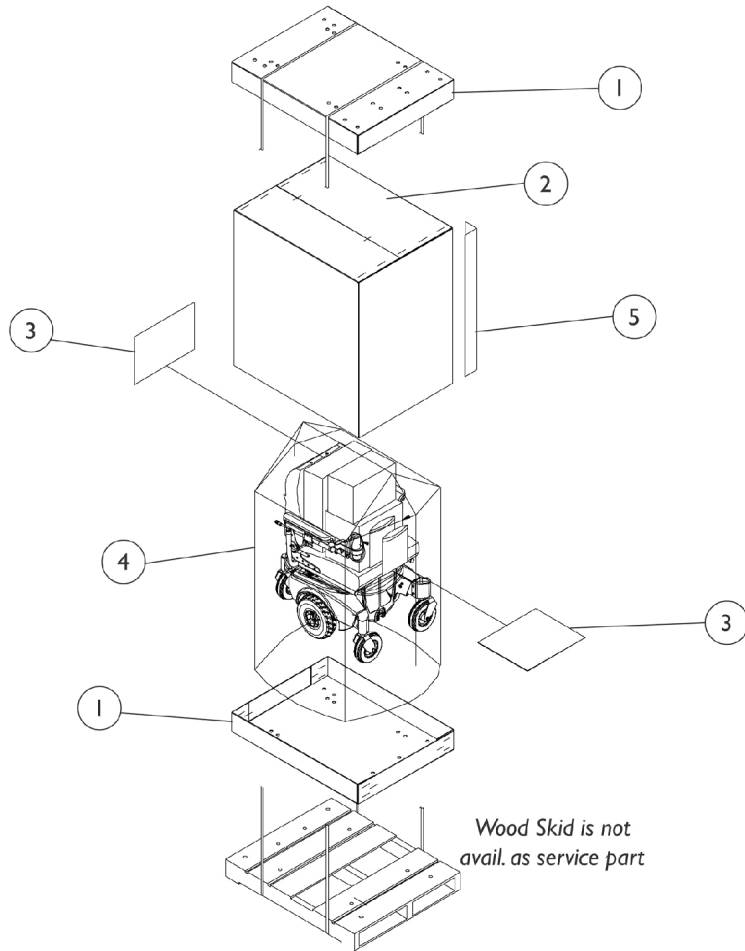

## Packaging, Literature and Decals

Item Number	Note	Part Number	Description	Quantity Per	
				Package	Assembly
1		1030362	Carton, Tray	1	2
2		1030364	Carton, Cover	1	1
3		40131X161	Insert, Plain Pad	1	2
4		1015592	Bag, Poly (72" L x 35" W x 19" D)	1	1
5		1115174	Carton, Corner Reinforcement	1	4
	A	1122147-NLA	NLA - Owner's Manual, Pronto M71 Jr.	1	1
	A,C	1114808-NLA	NLA - Instruction Manual, MK5 EX/ TT-EX Electronics	1	1
	A	1121907-NLA	NLA - Decal, Shroud - Pronto M71 Jr.	1	2
	B	1164348	Mailer, Return, Mercury Free	1	1
<p>NOTE: A - Not Shown            B - For Massachusetts providers only            C - Item is no longer available from the Invacare Service Parts Department. Refer to the Invacare Website under "Product Literature Search". Enter the part number in the "Keywords" field and download a free PDF version copy.</p> <p>NOTE: When adjusting or replacing parts, please refer to your owner's manual for assistance.</p>					