

# Flip-Up Adjustable Angle Footplates

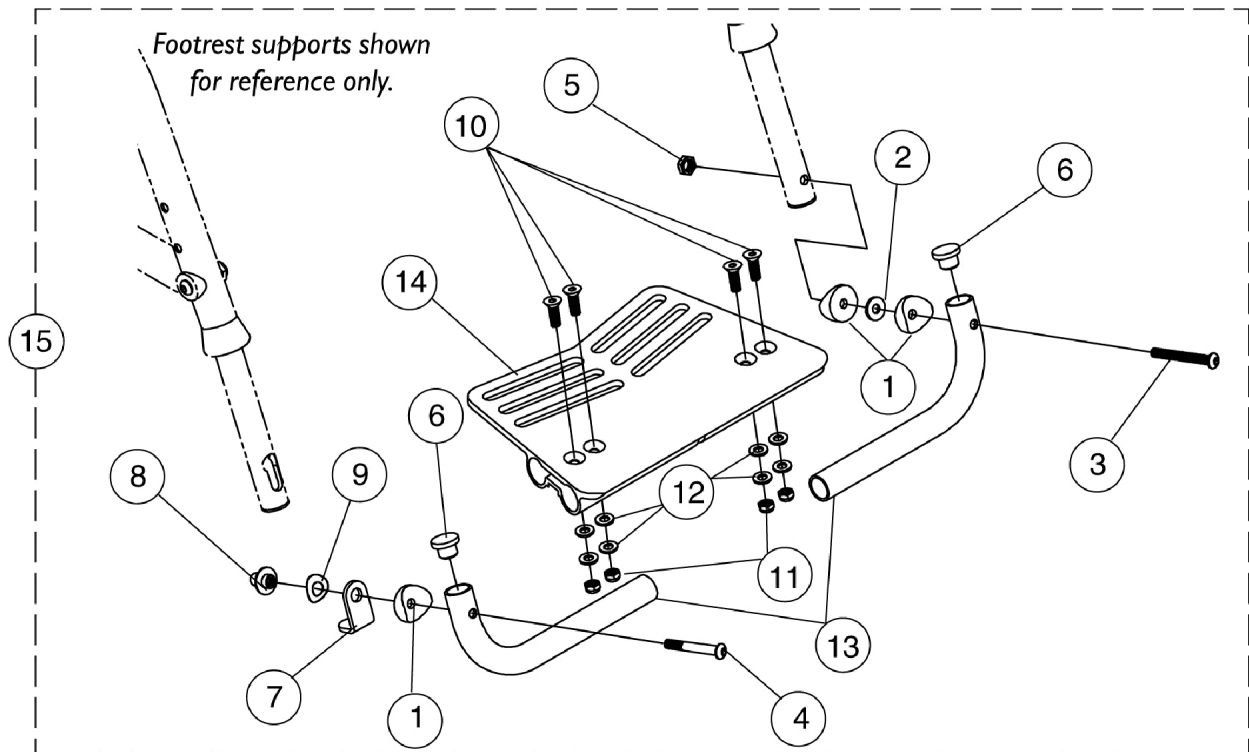

## Flip-Up Adjustable Angle Footplates

Item Number	Note	Part Number	Description	Quantity Per	
				Package	Assembly
1		1069059	Spacer, Coved (1/4 x 1/2 x 9/16")	1	3
2		1025456	Washer, Nylon (3/4 x 1/4 x 1/32")	1	1
3		1068505-NLA	NLA - Screw, Socket Button Head (1/4-28 x 2")	1	1
4		1059284-NLA	NLA - Screw, Socket Button Head (1/4-28 x 1-1/4")	1	1
5		1025765	Locknut (1/4-28)	1	1
6		1027097	Plug Button, Black (3/4")	1	2
7		1069041	Latch, Black	1	1
8		1068503	Knob	1	1
9		1068506	Washer, Wave (3/8 x 3/4 x 1/8")	1	1
10		1046421-NLA	NLA - Screw, Socket Flat Head (1/4-28 x 1")	1	4
11		1065362	Locknut (1/4-28)	1	4
12		1013971	Washer, Nylon (1/4 x 7/16 x 5/64")	1	8
13		1068821	Tube, Support, Footrest, Black	1	2
14	A	1046464-NLA	NLA - Footplate, One Piece Adjustable Angle, Black	1	1
14	B	1046466	Footplate, One Piece Adjustable Angle	1	1
15	A	1068932-NLA	NLA - One Piece Adjustable Angle Footplate Assembly	1	1
15	B	1068933	One Piece Adjustable Angle Footplate Assembly	1	1

NOTE: A - 14-15" Wide Chairs  
 B - 16-20" Wide Chairs