

# Vent Tray Mounting Hardware For Extruded Back Canes

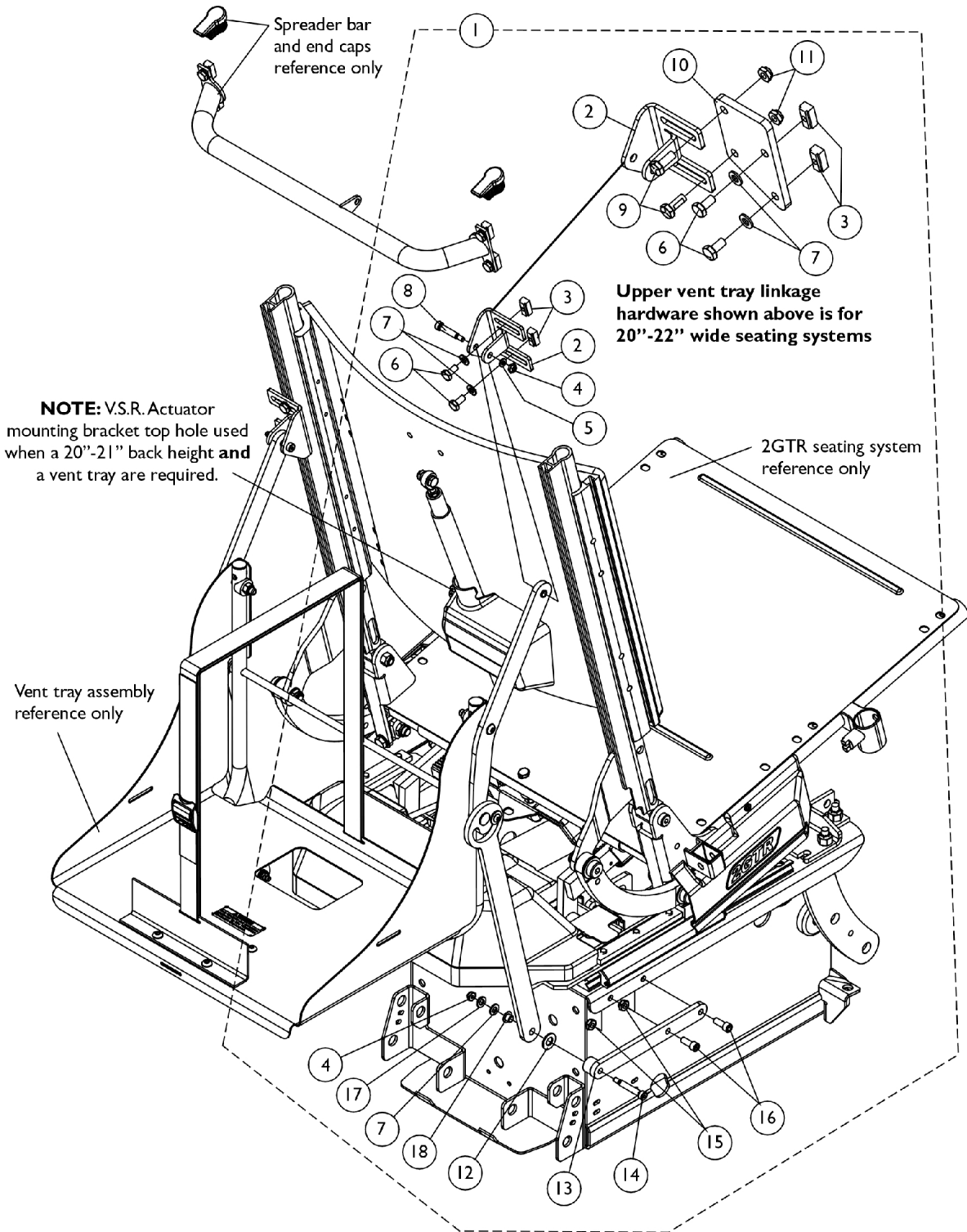

## Vent Tray Mounting Hardware For Extruded Back Canes

Item Number	Note	Part Number	Description	Quantity Per	
				Package	Assembly
1	A	1121260-NLA	NLA - Hardware, Vent Tray Mounting for 16"-19" Wide Seats with Extruded Canes	2	1
1	B	1121261-NLA	NLA - Hardware, Vent Tray Mounting for 20"-22" Wide Seats with Extruded Canes	2	1
2		1097191-NLA	NLA - Bracket, Upper Link, Black	1	2
3		1082699	T-Nut (1/4-20)	1	4
4		1026035-NLA	NLA - Locknut (#10-24)	1	4
5		1095360-NLA	NLA - Washer, Steel (7/8 x 3/8 x 1/16")	1	2
6		1078214	Screw, Hex Head w/ Patch (1/4-20 x 1/2")	1	4
7		1026907	Washer (1/4 x 1/2 x 1/16")	1	6
8		1098289-NLA	NLA - Screw, Shoulder Hex Socket Head (1/4 x 1", #10-24)	1	2
9		1078214	Screw, Hex Head w/ Patch (1/4-20 x 1/2")	1	4
10		1121021-NLA	NLA - Bracket, Seat Vent, Black (20 - 22" W)	1	2
11		1025195	Locknut (1/4-20)	1	4
12		1049527	Washer, Nylon (3/8 x 3/4 x 1/16")	1	2
13		1115815-NLA	NLA - Bracket, Vent Tray Attachment, Black	1	2
14		1000212	Screw, Shoulder Hex Socket (1/4 x 1-1/4", #10-24)	1	2
15		60275X000	Locknut (1/4-20)	1	4
16		1110468-NLA	NLA - Screw, Socket Head (1/4-20 x 5/8")	1	4
17		1007453	Lockwasher, Split (1/4")	1	2
18		1097179-NLA	NLA - Bushing, Flanged	1	2

NOTE: A - Includes items 2-8 and 12-18  
B - Includes items 2-18