

Back Mounting Hardware

(Infinity, Personal, JAY, Silhouette, Contour U Backs w/ Extruded Canes) (Profile Back w/ 7/8" Round Canes)

NOTE: V.S.R. is eliminated when back mounting hardware listed below is attached to Recline Only (2GR) and Tilt/Recline (2GTR) seating systems.

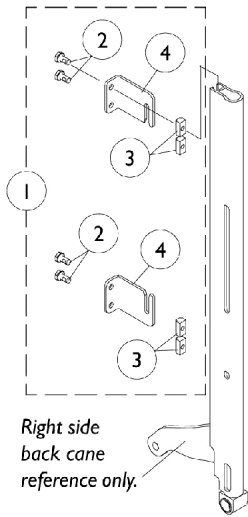

Infinity Back Mounting Hardware

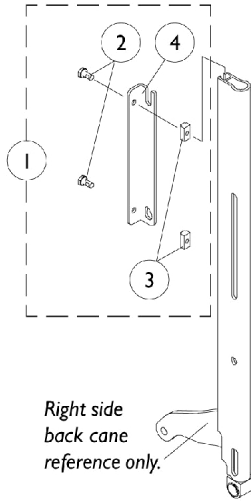

Personal Back Mounting Hardware

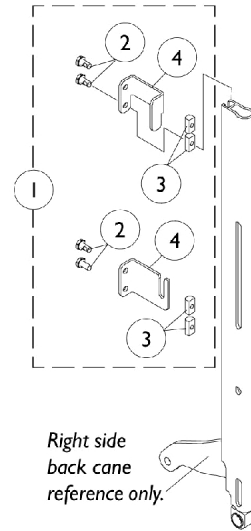

JAY Back Mounting Hardware

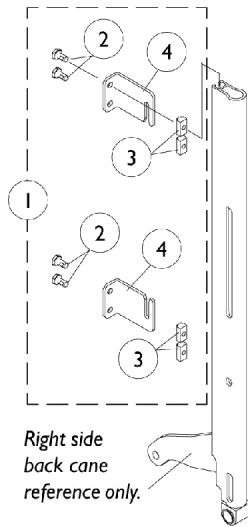

Silhouette Back Mounting Hardware

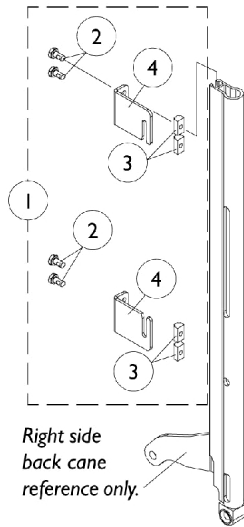

Contour U Back Mounting Hardware

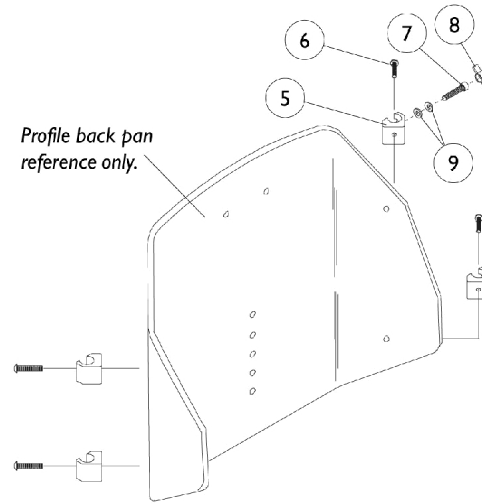

Profile Back Mounting Hardware For 7/8" Round Back Canes

Back Mounting Hardware

(Infinity, Personal, JAY, Silhouette, Contour U Backs w/ Extruded Canes)
(Profile Back w/ 7/8" Round Canes)

NOTE: V.S.R. is eliminated when back mounting hardware listed below is attached to Recline Only (2GR) and Tilt/Recline (2GTR) seating systems.

Item Number	Note	Part Number	Description	Quantity Per	
				Package	Assembly
1	A,M	1099776-NLA	NLA - Hardware, Infinity Back Mounting (Pair)	2	1
1	A,M,Q	1099778-NLA	NLA - Hardware, Personal Back Mounting (Pair)	2	1
1	A,M	1099777-NLA	NLA - Hardware, JAY Back Mounting (Pair)	2	1
1	A,M	1102697-NLA	NLA - Hardware, Contour U and Silhouette Back Mounting (Pair)	2	1
2	L	1028481-NLA	NLA - Screw, Socket Head (1/4-20 x 1/2")	1	8
2	L	1028481-NLA	NLA - Screw, Socket Head (1/4-20 x 1/2")	1	4
3	L	1082699	T-Nut (1/4-20)	1	8
3	L	1082699	T-Nut (1/4-20)	1	4
4	B	1099654-NLA	NLA - Brackets, Back Mounting, Black	1	2
4	C	1099655-NLA	NLA - Brackets, Back Mounting, Black	1	2
4	D	1099656-NLA	NLA - Brackets, Back Mounting, Black	1	1
4	E	1099657-NLA	NLA - Brackets, Back Mounting, Black	1	1
4	F	1099650-NLA	NLA - Brackets, Back Mounting, Black	1	1
4	G	1099651-NLA	NLA - Brackets, Back Mounting, Black	1	1
4	H	1099652-NLA	NLA - Brackets, Back Mounting, Black	1	1
4	I	1099653-NLA	NLA - Brackets, Back Mounting, Black	1	1
5	K,P	0190500-NLA	NLA - Block, Glide (16", 18" and 20" Wide)	1	4
5	K,P	0190600-NLA	NLA - Block, Glide (17" and 19" Wide)	1	4
6	N,P	0052906-NLA	NLA - Screw, Socket Button Head (1/4-20 x 3/4")	1	4
6	O,P	0051206-NLA	NLA - Screw, Machine, Hex Socket, Button Head (1/4-20 x 1-1/4)	1	4
7	P	1003545	Screw, Socket Head (1/4-20 x 1-1/4")	1	2
8	P	0226500-NLA	NLA - Knob, Tee	1	2
9	P	0050100-NLA	NLA - Washer, Nylon Flat (1/4 x 1/2 x 1/16")	1	4
	J	1086460	Grip, Foam, Hand (4-1/2" L)	1	2

Back Mounting Hardware

(Infinity, Personal, JAY, Silhouette, Contour U Backs w/ Extruded Canes) (Profile Back w/ 7/8" Round Canes)

NOTE: V.S.R. is eliminated when back mounting hardware listed below is attached to Recline Only (2GR) and Tilt/Recline (2GTR) seating systems.

- NOTE:
- A - Includes Items 2-4
 - B - Infinity Back - Upper Left or Lower Right
 - C - Infinity Back - Upper Right or Lower Left
 - D - Personal Back - Right
 - E - Personal Back - Left
 - F - JAY Back - Upper Right
 - G - JAY Back - Upper Left
 - H - JAY Back - Lower Right, Contour U Back - Upper Right or Lower Left (2 each assembly), Silhouette Back - Upper Left or Lower Right (2 each assembly)
 - I - JAY Back - Lower Left, Contour U Back - Upper Left or Lower Right (2 each assembly), Silhouette Back - Upper Right or Lower Left (2 each assembly)
 - J - Not Shown
 - K - New foam grips are required when mounting sliding glide blocks onto the 7/8" round back canes. Existing foam grips will need to be replaced.
 - L - Infinity, JAY, Contour U and Silhouette Backs have 8 ea. assembly where as Personal Back has 4 ea. assembly.
 - M - V.S.R. is eliminated when back mounting hardware is attached to recline only (2GR) and tilt/recline (2GTR) seating systems.
 - N - 16, 18, 20 Wide
 - O - 17 and 19 Wide
 - P - Profile Back Mounting Hardware for 7/8" round canes consist of the following: 4 each of (#0190500 and #0052906 for 16", 18", 20" wide or #0190600 and #0050100 for 17", 19" wide) and 2 each of #1003545, #1056269, #1086460.
 - Q - Personal Back mounting hardware part number 1099778 is not compatible with the new Personal Back 10 and Personal Back 10 Plus models.