

Front Rigging Hanger Assembly

NOTE: Front rigging hanger assemblies and seat pans share the same mounting hardware for an A.S.B.A. seat. See Seat Pan and Mounting Hardware page.

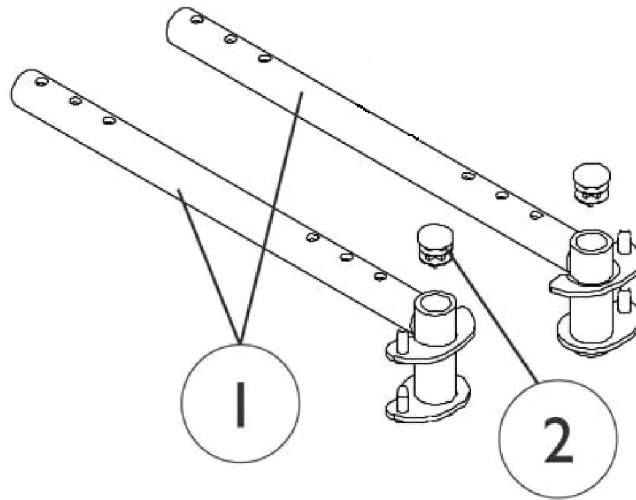

| Item Number | Note | Part Number | Description | Quantity Per | |
|-------------|------|-------------|--|--------------|----------|
| | | | | Package | Assembly |
| 1 | | 1114766 | Front Rigging Hanger Assembly w/ Plug Button, Pin Style, Hemi, Black - Right (12 - 21" D) | 1 | 1 |
| 1 | | 1114767 | Front Rigging Hanger Assembly w/ Plug Button, Pin Style, Hemi, Black - Left (12 - 21" D) | 1 | 1 |
| 1 | | 1132339-NLA | NLA - Front Rigging Hanger Assembly w/ Plug Button, Pin Style, Hemi, Black - Right (22" D) | 1 | 1 |
| 1 | | 1132340-NLA | NLA - Front Rigging Hanger Assembly w/ Plug Button, Pin Style, Hemi, Black - Left (22" D) | 1 | 1 |
| 2 | | 1027097 | Plug Button, Black (3/4") | 1 | 1 |