

MKIV Joysticks

RX, A, A+, TCHJOY

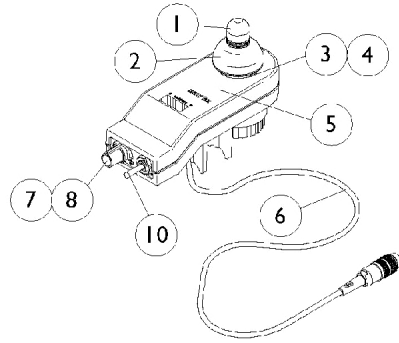

1038603
RX Joystick

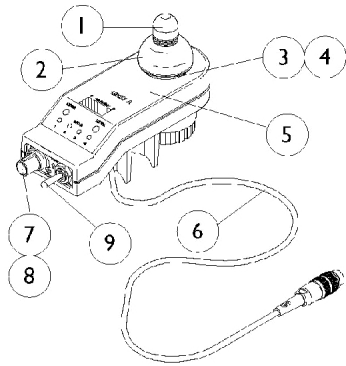

1065944
A Joystick

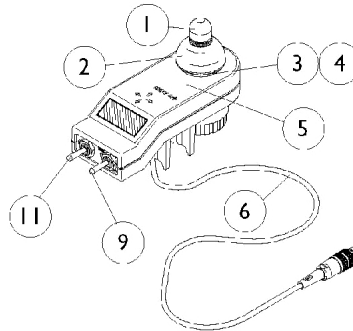

1038608
A+ Joystick

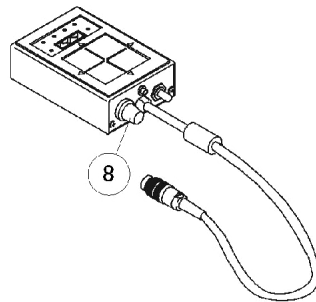

1095289
TCHJOY
Touchpad "A"
Joystick

MKIV Joysticks

RX, A, A+, TCHJOY

RX, A, A+, TCHJOY

Item Number	Description	RX	A	A+	TCHJOY
See Pictorial	Joystick Assembly	1038603-NLA	1065944-NLA	1038608-NLA	1095289-NLA
1	Knob, Joystick	1040217	1040217	1040217	N/A
2	Skirt, Joystick	1040218	1040218	1040218	N/A
3	Inductive, Joystick	1036764-NLA See Note(s) B	1036764-NLA See Note(s) B	1036764-NLA See Note(s) A	N/A
3	Inductive, Joystick	1104397-NLA See Note(s) C	1104397-NLA See Note(s) C	N/A	N/A
4	Boot, Joystick	50000X364-NLA	50000X364-NLA	50000X364-NLA	N/A
5	Overlay, Joystick Decal	1038642-NLA	1040190-NLA	1036776-NLA	N/A
6	Cable Assembly	1036750-NLA See Note(s) B	1036750-NLA See Note(s) B	1036750-NLA See Note(s) A	N/A
6	Cable Assembly	1104205-NLA See Note(s) C	1104205-NLA See Note(s) C	N/A	N/A
7	Potentiometer, Speed	1040225-NLA See Note(s) B	1040225-NLA See Note(s) B	N/A	N/A
7	Potentiometer, Speed	1115518-NLA See Note(s) C	1115518-NLA See Note(s) C	N/A	N/A
8	Knob, Potentiometer	1025516-NLA	1025516-NLA	N/A	1025516-NLA
9	Switch, On/ Off Momentary	N/A	1040185-NLA See Note(s) B	1040185-NLA See Note(s) A	N/A
9	Switch, On/ Off Momentary	N/A	1115523-NLA See Note(s) C	N/A	N/A
10	Switch, Off/ 1-2	1038627-NLA See Note(s) B	N/A	N/A	N/A
10	Switch, Off/ 1-2	1115521-NLA See Note(s) C	N/A	N/A	N/A
11	Switch, Program	N/A	N/A	1040186-NLA See Note(s) A	N/A

NOTE: A - Item requires soldering
 B - Before 10/01/02 item requires soldering
 C - After 9/30/02 item has a non-solder connector