

# MKIV Joysticks

## Excel, RII, RX, A, A+, Tchjoy

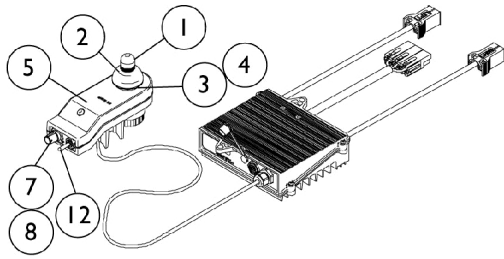

**\* 1080723NLA**  
**RII Joystick/Controller**

\* For chairs made before 5/1/00,  
 the following must be ordered:  
 RII Joystick part #1092610  
 RII Retro Controller part #1095269  
 Remote Programmer part #1093248

**1080953NLA**  
**EXCEL Joystick/L.P.Controller**  
**Before 5/1/00**

⊕ For chairs made before 5/1/00,  
 the following must be ordered:  
 RII Joystick part #1092610  
 RII L.P. Retro Controller part #1095270  
 Remote Programmer part #1093248

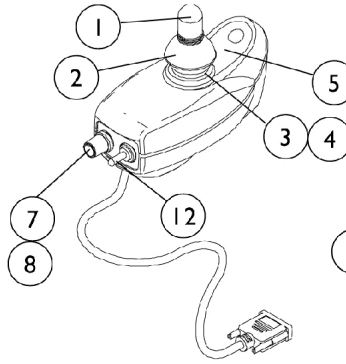

**1092610**  
**RII & Excel Joystick**  
**After 4/30/00**

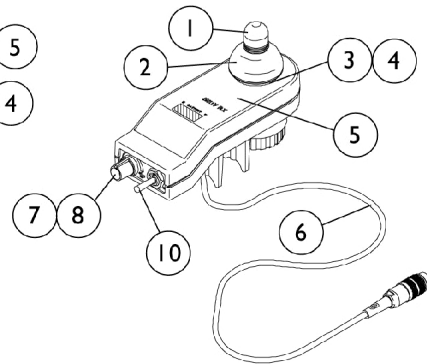

**1038603**  
**RX Joystick**

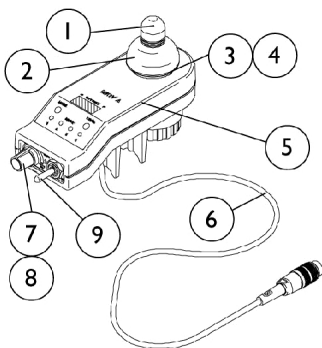

**1065944**  
**A Joystick**

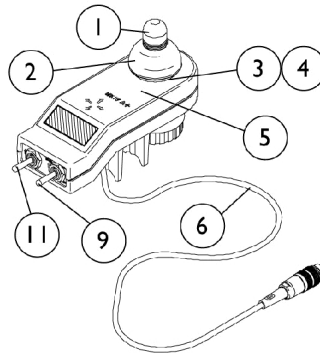

**1038608**  
**A+ Joystick**

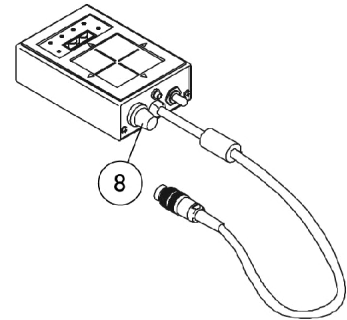

**1095289**  
**TCHJOY**  
**Touchpad "A"**  
**Joystick**

# MKIV Joysticks

## Excel, RII, RX, A, A+, Tchjoy

Item Number	Note	Part Number	Description	Quantity Per	
				Package	Assembly
	A,D	1080723-NLA	NLA - Joystick/Controller, MKIV RII	1	1
	B,D	1080953-NLA	NLA - Joystick/Controller, MKIV RII L.P	1	1
	C	1095269-NLA	NLA - Controller, MKIV RII, Retro	1	1
	C	1095270-NLA	NLA - Controller, MKIV RII, Retro L.P.	1	1
	C	1109091-NLA	NLA - Programmer, Remote	1	1
	C	See Chart	Item#s 1-12 MKIV Joysticks	1	1

NOTE: A - For RII model chairs made before 5/1/00, the following must be ordered, RII Joystick #1092610, RII Retro Controller #(1095269) and Remote Programmer part #(1109091)  
 B - For EXCEL model chairs made before 5/1/00, the following must be ordered, RII Joystick #1092610, RII L.P Retro Controller #1095270 and Remote Programmer #1109091.  
 C - Not Shown.  
 D - For joystick inductive and switch components, refer to chart under RII joystick assembly #1092610.

Item Number	Description	RII and Excel After 4/30/00	RX	A	A+	TCHJOY
See Pictorial	Joystick Assembly	1092610-NLA	1038603-NLA	1065944-NLA	1038608-NLA	1095289-NLA
1	Knob, Joystick	1040217	1040217	1040217	1040217	N/A
2	Skirt, Joystick	1040218	1040218	1040218	1040218	N/A
3	Inductive, Joystick	1036764-NLA See Note(s) B	1036764-NLA See Note(s) C	1036764-NLA See Note(s) C	1036764-NLA See Note(s) B	N/A
3	Inductive, Joystick	N/A	1104397-NLA See Note(s) D	1104397-NLA See Note(s) D	N/A	N/A
4	Boot, Joystick	50000X364-NL A	50000X364-NL A	50000X364-NL A	50000X364-NL A	N/A
5	Overlay, Joystick Decal	1049692-NLA See Note(s) A	1038642-NLA	1040190-NLA	1036776-NLA	N/A
6	Cable Assembly	N/A See Note(s) A	1036750-NLA See Note(s) C	1036750-NLA See Note(s) C	1036750-NLA See Note(s) B	N/A
6	Cable Assembly	N/A	1104205-NLA See Note(s) D	1104205-NLA See Note(s) D	N/A	N/A
7	Potentiometer, Speed	1040225-NLA See Note(s) B	1040225-NLA See Note(s) C	1040225-NLA See Note(s) C	N/A	N/A
7	Potentiometer, Speed	N/A	1115518-NLA See Note(s) D	1115518-NLA See Note(s) D	N/A	N/A
8	Knob, Potentiometer	1025516-NLA	1025516-NLA	1025516-NLA	N/A	1025516-NLA
9	Switch, On/Off Momentary	N/A	N/A	1040185-NLA See Note(s) C	1040185-NLA See Note(s) B	N/A
9	Switch, On/Off Momentary	N/A	N/A	1115523-NLA See Note(s) D	N/A	N/A
10	Switch, Off/ 1-2	N/A	1038627-NLA See Note(s) C	N/A	N/A	N/A

# MKIV Joysticks

## Excel, RII, RX, A, A+, Tchjoy

Item Number	Description	RII and Excel After 4/30/00	RX	A	A+	TCHJOY
10	Switch, Off/ 1-2	N/A	1115521-NLA See Note(s) D	N/A	N/A	N/A
11	Switch, Program	N/A	N/A	N/A	1040186-NLA See Note(s) B	N/A
12	Switch, Toggle SPDT	1010042-NLA See Note(s) B	N/A	N/A	N/A	N/A

NOTE: A - Cable assembly and joystick overlay decal for RII joystick before 10/01/02 and after 9/30/02 are not available.  
 B - Item requires soldering.  
 C - Before 10/01/02 item requires soldering.  
 D - After 9/30/02 item has a non-solder connector.