

Solid Folding Seat Permanent & Removable Arm EX only

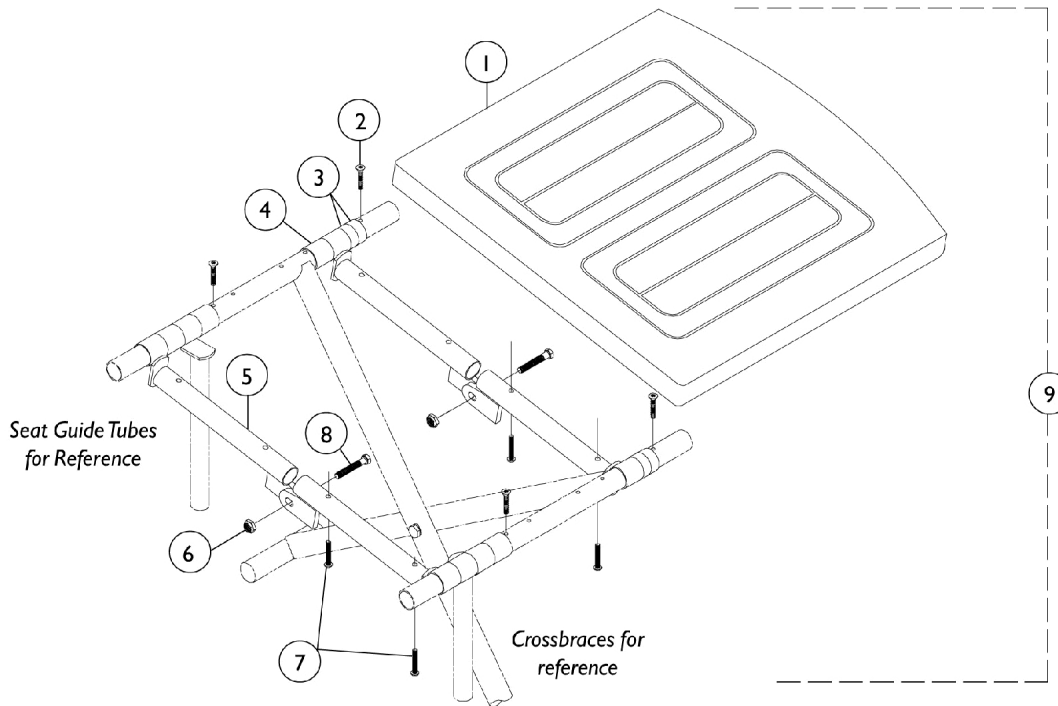

Item Number	Note	Part Number	Description	Quantity Per	
				Package	Assembly
1		8881105955	Upholstery, Seat, Solid, Vinyl (18" Wide Chair)	1	1
1		8881105954	Upholstery, Seat, Solid, Vinyl (16-1/2" Wide Chairs)	1	1
2		20228X013-NLA	NLA - Screw, Phillips Oval Head (#10 x 7/8")	1	4
3		47397X024	Spacer (7/8 x 1 x 7/16")	1	4
4		47397X019	Spacer (7/8 x 1 x 1")	1	3
5		1012979-NLA	NLA - Crossbrace, Chrome (18" W)	1	4
5		1012976-NLA	NLA - Crossbrace, Chrome (16-1/2" W)	1	4
6		60290X002	Locknut (5/16-18)	1	2
7		11008X011	Screw, Phillips Round Head (#10-32 x 1-3/8")	1	4
8		12144X000	Screw, Hex Head (5/16-18 x 1")	1	2
9	A	8881105959-NL A	NLA - Seat, Solid Folding (18" W)	1	1
9	A	8881105958-NL A	NLA - Seat, Solid Folding (16-1/2" W)	1	1
9	B	8881105957-NL A	NLA - Seat, Solid Folding (18" W)	1	1
9	B	8881105956-NL A	NLA - Seat, Solid Folding (16-1/2" W)	1	1
	C,D	1036813-NLA	NLA - Instruction Sheet	1	1

NOTE: A - Used on Chairs with Removable Arms.
 B - Used on Chairs with Permanent Arms.
 C - Not Shown.
 D - Item is no longer available from the Invacare Service Parts Department. Refer to the Invacare Website under "Product Literature Search". Enter the part number in the "Keywords" field and download a free PDF version copy.