

Insignia™ Wheelchair



Yes, you can.

Parts Catalog Usage Guide

The information contained in this document is subject to change without notice. This catalog contains service parts for Form No. 09-089. If you have any questions regarding this catalog, please contact one of our Customer Service Representatives.

For Customer Service Support Call:

1-800-333-6900

For Faxed In Orders Call:

1-800-678-4682 or

1-440-366-0709

For Technical Service Call:

1-800-832-4707

Literature Can Be Found at:

www.invacare.com or

1-800-828-6272

SYMBOL DEFINITION

Throughout this catalog you will notice letters to draw your attention to specific footnotes which are located at the bottom of the page or below specified charts.

Examples:

A,B,C etc. = Special Comments

NOTE: = General information pertaining to that specific page

NLA = No Longer Available

HARDWARE MEASUREMENTS

The measurements for the hardware will be listed as follows:

Screws, Bolts Diameter X Thread Count/Pitch X Length

Washers Inside Diameter X Outside Diameter X Thickness

Spacers Inside Diameter X Outside Diameter X Length

For your convenience, we have supplied an area for you to list your Invacare Representatives.

Name	Phone Numbers

© 2015 Invacare Corporation, Elyria, Ohio. Invacare, the Medallion Design and Yes, you can. are trademarks; Insignia is a trademark of Invacare Corporation.

TABLE of CONTENTS

Description	Page Number
Accessories - Miscellaneous	8
Arm and Frame Assemblies	3
Upholstery, Seat and Back	4
Wheels and Casters	6

Arm and Frame Assemblies



Item Number	Note	Part Number	Description	Quantity Per	
				Package	Assembly
1		1165182	T-Arm Assembly, Removable, Black (Pair)	2	1
2		1165202	Kit, Arm Frame Assembly w/ Guard - Right	1	1
2		1165203	Kit, Arm Frame Assembly w/ Guard - Left	1	1

Upholstery, Seat and Back

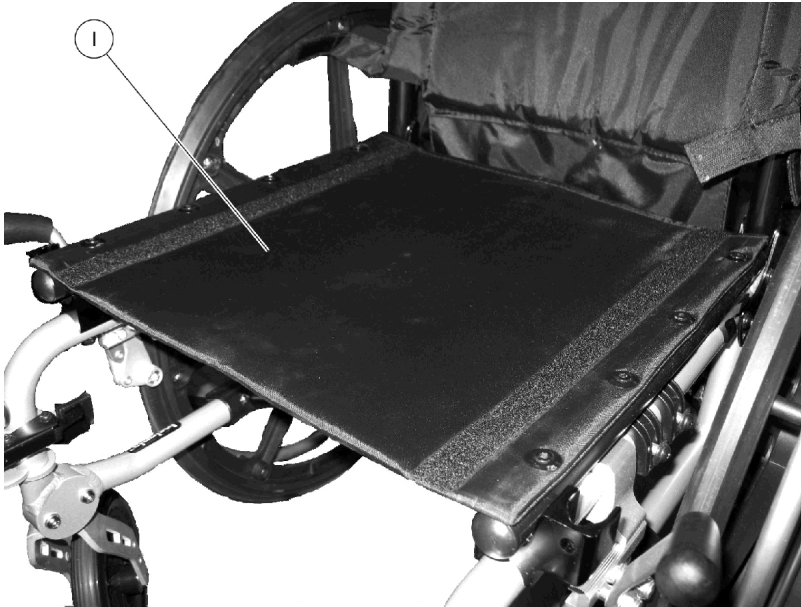

Upholstery, Seat and Back

Item 1 Seat Upholstery

Seat Width	Seat Depth	Color	Material	Part Number
16"	16"	Black	Nylon	1165196
16"	18"	Black	Nylon	1165199
18"	16"	Black	Nylon	1165197
18"	18"	Black	Nylon	1165200
20"	18"	Black	Nylon	1165201

Item 2 Back Upholstery

Back Width	Color	Material	Part Number
16"	Black	Nylon	1165193
18"	Black	Nylon	1165194
20"	Black	Nylon	1165195

Back Height ranges from 15" to 19" in one inch increments.

Wheels and Casters

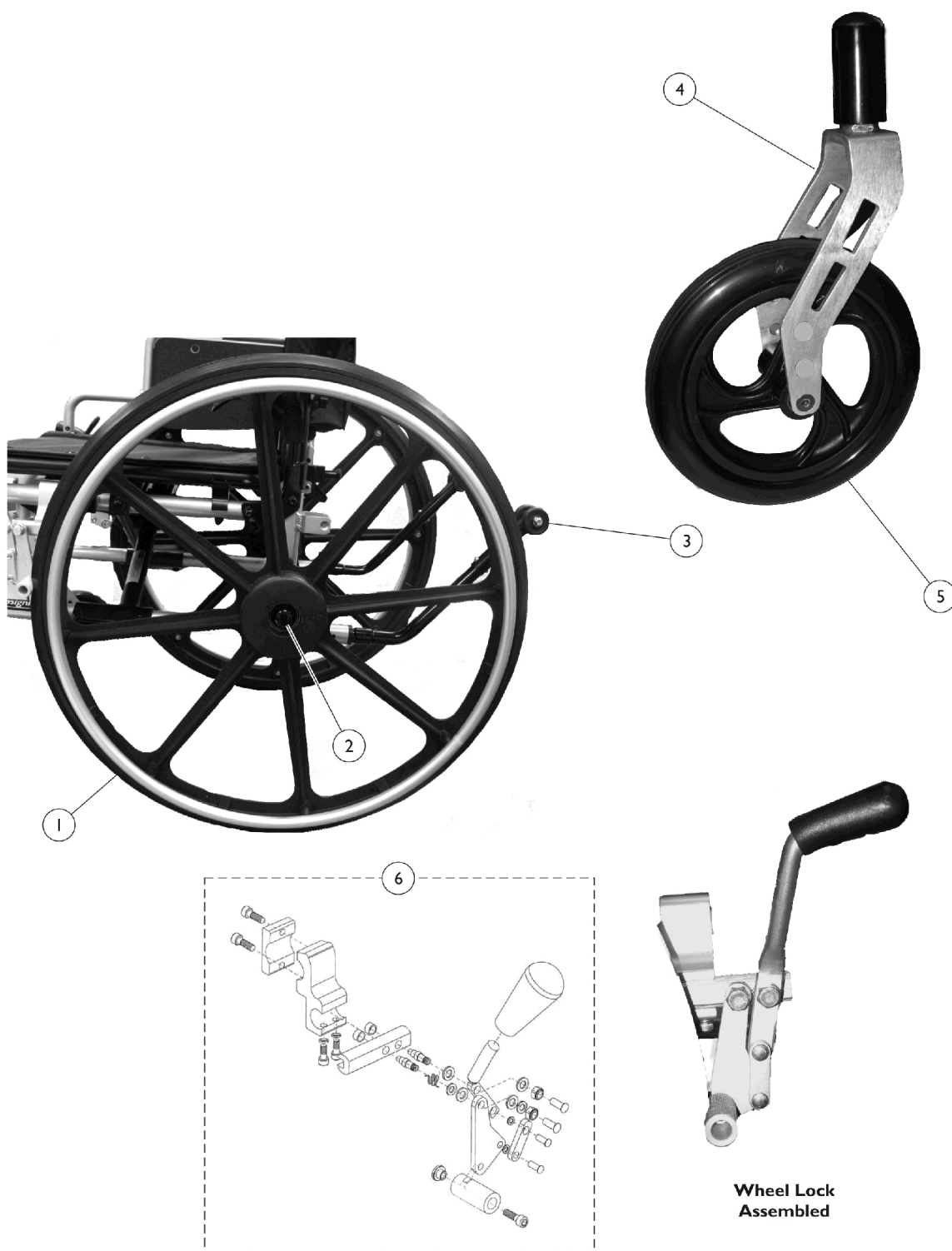

Wheels and Casters

Item Number	Note	Part Number	Description	Quantity Per	
				Package	Assembly
1		1165188	Composite Wheel Assembly w/ Aluminum Handrim, Urethane (24")	1	2
1	A	1165878	Composite Wheel Assembly w/ Aluminum Handrim, Pneumatic w/ Flat Free (24")	1	2
2		1165187	Axle, Quick Release	1	2
3		1165186	Kit, Anti-Tipper (Pair)	2	1
4		1165190	Headtube, Fork and Caster Assembly	1	2
5		1165189	Caster, Front w/ Mounting Hardware	1	2
6	B	1165191	Kit, Wheel Lock - Left	1	1
6	B	1165192	Kit, Wheel Lock - Right	1	1
NOTE: A - Not shown in photo. B - Includes the Wheel Lock and all attaching hardware as shown. Replacement Wheel Lock Grips are available, see category "Accessories - Miscellaneous" for the part number.					

Accessories - Miscellaneous

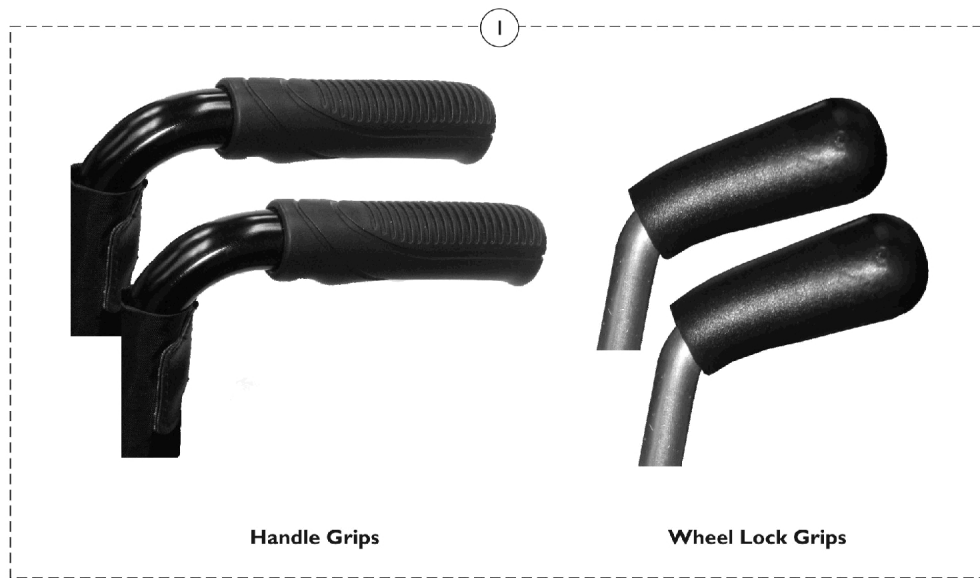

Item Number	Note	Part Number	Description	Quantity Per	
				Package	Assembly
1	A	1165183	Kit, Handle and Wheel Lock Grips, Black	4	1
2		1165185	Kit, Knobs, Cane Adjustment, Black (Pair)	2	1
3		1165184	Kit, Seat Extension (2")	1	1
	B	1169181	Kit, Back Canes (Pair)	2	1

NOTE: A - Includes (2) each of Handle Grip and (2) each of Wheel Lock Grip.
B - Not shown.

Invacare Corporation

www.invacare.com



Yes, you can.

One Invacare Way
Elyria, Oh USA
44036-2125
800-333-6900

Technical Support
800-832-4707
Customer Service
800-333-6900

Literature Orders
800-333-6900

© 2015 Invacare Corporation. All rights reserved. Republication, duplication or modification in whole or in part is prohibited without prior written permission from Invacare. Trademarks are identified as [™] and ®. All trademarks are owned by or licensed to Invacare Corporation or its subsidiaries unless otherwise noted.
(Revised 01/19/15)

Form No. 09-089