

PADDED ACTUATOR COVER
PART NO. 1083039



Assembly, Installation and Operating Instructions

NOTE: Check all parts for shipping damage. In case of damage, DO NOT use. Contact your Dealer for further instruction.

SAFETY SUMMARY

The following recommendations are made for the safe use of the PADDED ACTUATOR COVER:

GENERAL WARNINGS

The Padded Actuator Cover is for use ONLY on the following lifts: RPA 450-1, RPL 450-1 and RPA 600-1.

DO NOT install or use this equipment without first reading and understanding these instructions. If you are unable to understand the Warnings, Cautions or Instructions, contact a healthcare professional, dealer or technical personnel before attempting to install this equipment - otherwise, injury or damage may occur.

After ANY adjustments, repair or service and BEFORE use, make sure all attaching hardware is tightened securely - otherwise injury or damage may occur.

INSTALLATION WARNING

Caster locks MUST be locked during this procedure to prevent injury or damage.

CAUTION

DO NOT tumble dry the actuator cover.

INSTALLING/REMOVING THE ACTUATOR COVER (FIGURE 1)

1. Lock the casters as shown in **DETAIL "A"**.
2. Remove the metal ring attached to the RED emergency release pin as shown in **DETAIL "D"**.
3. Lift-up on the boom and place it on your shoulder.
4. Remove the nut, bolt and washer securing the actuator shaft extension to the boom mounting bracket.
5. Remove the pinch guard and bushing from the actuator shaft extension.
6. Let the actuator rest on your chest.
7. Perform one (1) of the following:
 - A. Install the actuator cover by sliding the large opening of the padded actuator cover over the actuator assembly.

*NOTE: Ensure large opening is pulled all the way down, with elastic band under actuator base. Ensure RED emergency release pin protrudes through small hole in actuator cover as shown in **DETAIL "B"**.*

 - B. Remove the actuator cover.
8. Rotate the actuator shaft extension until it lines-up with the holes in the boom mounting bracket.

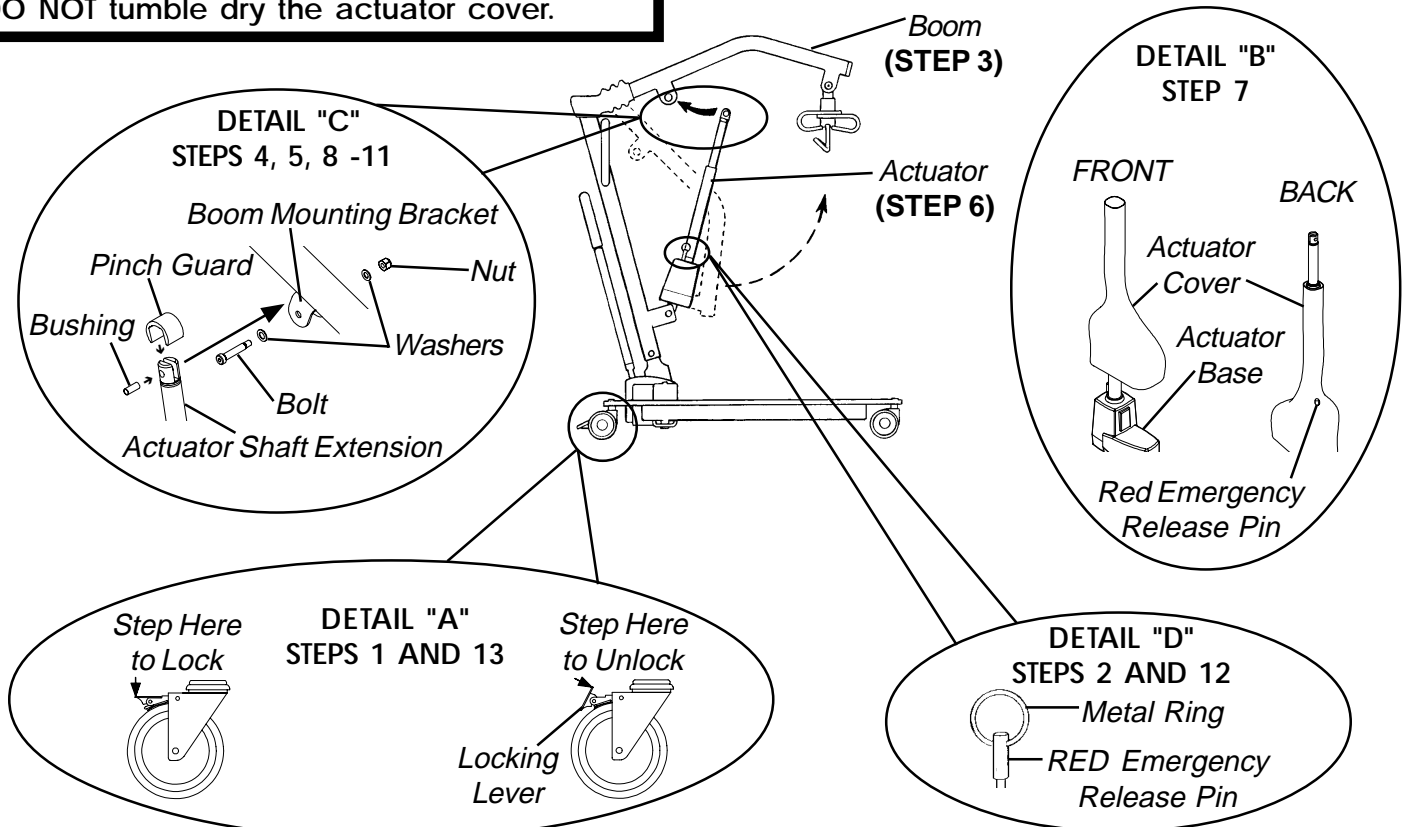

FIGURE 1 - INSTALLING/REMOVING THE ACTUATOR COVER

9. Place the pinch guard over the actuator shaft extension.
10. Align the boom mounting bracket holes with those of the actuator shaft extension and insert the bushing through both sets of holes as shown in **DETAIL "C"**.
11. Secure with bolt, nut and washer(s).
12. Reattach the metal ring to the RED emergency release pin.
13. Unlock the casters as shown in **DETAIL "A"**.

NOTE: Ensure the bolt is completely through the holes of the boom mounting bracket and the actuator shaft extension. The boom assembly will pivot easily if the mounting hardware is aligned properly when the boom assembly is secured to the mast.

CAUTION

DO NOT overtighten the nut and bolt. Overtightening may bend the mounting bracket.

LIMITED WARRANTY

PLEASE NOTE: THE WARRANTY BELOW HAS BEEN DRAFTED TO COMPLY WITH FEDERAL LAW APPLICABLE TO PRODUCTS MANUFACTURED AFTER JULY 4, 1975.

This warranty is extended only to the original purchaser/user of our products.

This warranty gives you specific legal rights and you may also have other legal rights which vary from state to state.

Invacare warrants its product to be free from defects in materials and workmanship for one (1) year for the original purchaser. If within such warranty period any such product shall be proven to be defective, such product shall be repaired or replaced, at Invacare's option. This warranty does not include any labor or shipping charges incurred in replacement part installation or repair of any such product. Invacare's sole obligation and your exclusive remedy under this warranty shall be limited to such repair and/or replacement.

For warranty service, please contact the dealer from whom you purchased your Invacare product. In the event you do not receive satisfactory warranty service, please write directly to Invacare at the address on the bottom of the page. Provide dealer's name, address, model number, date of purchase, indicate nature of the defect and, if the product is serialized, indicate the serial number.

Invacare Corporation will issue a return authorization. The defective unit or parts must be returned for warranty inspection using the serial number, when applicable, as identification within thirty (30) days of return authorization date. DO NOT return products to our factory without our prior consent. C.O.D. shipments will be refused; please prepay shipping charges.

LIMITATIONS AND EXCLUSIONS: THE WARRANTY SHALL NOT APPLY TO PROBLEMS ARISING FROM NORMAL WEAR OR FAILURE TO ADHERE TO THE ENCLOSED INSTRUCTIONS. IN ADDITION, THE FOREGOING WARRANTY SHALL NOT APPLY TO SERIAL NUMBERED PRODUCTS IF THE SERIAL NUMBER HAS BEEN REMOVED OR DEFACED; PRODUCTS SUBJECTED TO NEGLIGENCE, ACCIDENT, IMPROPER OPERATION, MAINTENANCE OR STORAGE; OR PRODUCTS MODIFIED WITHOUT INVACARE'S EXPRESS WRITTEN CONSENT INCLUDING, BUT NOT LIMITED TO: MODIFICATION THROUGH THE USE OF UNAUTHORIZED PARTS OR ATTACHMENTS; PRODUCTS DAMAGED BY REASON OF REPAIRS MADE TO ANY COMPONENT WITHOUT THE SPECIFIC CONSENT OF INVACARE; PRODUCTS DAMAGED BY CIRCUMSTANCES BEYOND INVACARE'S CONTROL; PRODUCTS REPAIRED BY ANYONE OTHER THAN AN AUTHORIZED INVACARE DEALER, SUCH EVALUATION SHALL BE SOLELY DETERMINED BY INVACARE.

THE FOREGOING WARRANTY IS EXCLUSIVE AND IN LIEU OF ALL OTHER EXPRESS WARRANTIES, IF ANY, INCLUDING THE IMPLIED WARRANTIES OF MERCHANTABILITY AND FITNESS FOR A PARTICULAR PURPOSE.

IT SHALL NOT EXTEND BEYOND THE DURATION OF THE EXPRESSED WARRANTY PROVIDED HEREIN AND THE REMEDY FOR VIOLATIONS OF ANY IMPLIED WARRANTY SHALL BE LIMITED TO REPAIR OR REPLACEMENT OF THE DEFECTIVE PRODUCT PURSUANT TO THE TERMS CONTAINED HEREIN. INVACARE SHALL NOT BE LIABLE FOR ANY CONSEQUENTIAL OR INCIDENTAL DAMAGES WHATSOEVER.

THIS WARRANTY SHALL BE EXTENDED TO COMPLY WITH STATE/PROVINCIAL LAWS AND REQUIREMENTS.



INVACARE CORPORATION • ONE INVACAREWAY • ELYRIA, OHIO 44035-2125 • 1-800-333-6900